

# BLACK SHEEP MILWAUKEE

216 S 2nd St. • Milwaukee, WI 53204

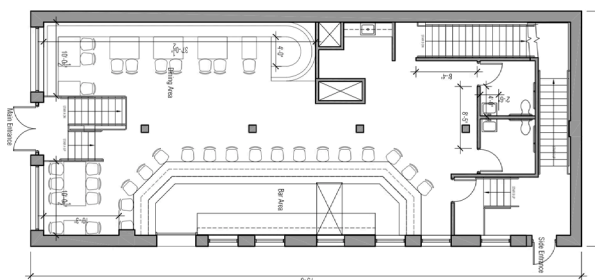

## VENUE POINT OF CONTACT

**Mike Sorge**

414-698-8315

mike@blacksheepmke.com

www.blacksheepmke.com

## VENUE DESCRIPTION

Industrial chic wine bar and restaurant located in Historic Walker's Point. Featuring a self service wine machine and Chef derived modern American cuisine.

## VENUE INFORMATION

**Capacity:** 160

**Number of Event Spaces:** 2

**Outdoor Space:** Yes

**ADA Accessible:** No

**Employee Makeup:** Non-Union Employees

**Venue Ownership:** --

## VENUE BREAKDOWN

**Space Sq Ft:** 2600 sq ft

**Largest Capacity Space:** 100

**Cocktail Capacity:** 160

**Theater Capacity:** 20

**Classroom Capacity:** 20

**Boardroom Capacity:** 20

**Banquet Capacity:** 120

## VENUE CAN ACCOMMODATE

Seated Breakfast

Buffet Breakfast

Seated Lunch

Buffet lunch

Cocktail Reception

Seated Dinner

Buffet Dinner

Boardroom Style Event

Live Performance

Without Stage

Late Night Event

The information included in this listing has been provided by the venue.

Para español, por favor visite [milwaukee2020.com/venue-search](http://milwaukee2020.com/venue-search).

**For more information, visit [milwaukee2020.com/venue-search](http://milwaukee2020.com/venue-search).**