



VENUE POINT OF CONTACT

David Cecsarini

414-940-7780

cez@nextact.org

www.nextact.org

VENUE DESCRIPTION

Our 152-seat house is divided into three sections of raised seating located center, left and right of the thrust stage. Lobby amenities include patron restrooms, ticket office and a full bar serving soft drinks and alcohol. The rehearsal hall may be configured in multiple arrangements

VENUE INFORMATION

Capacity: 152

Number of Event Spaces: 1

Outdoor Space: No

ADA Accessible: Yes

Employee Makeup: Non-Union Employees

Venue Ownership: --

VENUE BREAKDOWN

Space Sq Ft: 5,221 Sq Ft

Largest Capacity Space: 152

Cocktail Capacity: n/a

Theater Capacity: 152

Classroom Capacity: n/a

Boardroom Capacity: n/a

Banquet Capacity: n/a

VENUE CAN ACCOMMODATE

Buffet Breakfast

Cocktail Reception

Panel Discussion

Theater Style Event

Live Performance

With Stage

Late Night Event

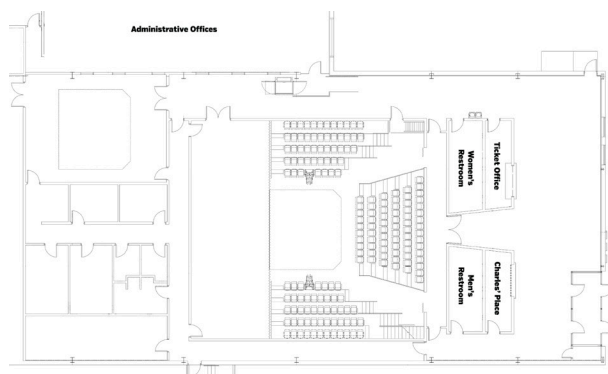

The information included in this listing has been provided by the venue.

Para español, por favor visite milwaukee2020.com/venue-search.

For more information, visit milwaukee2020.com/venue-search.