

PRESERVATION PARK

925 W Juneau Avenue • Milwaukee, WI 53233

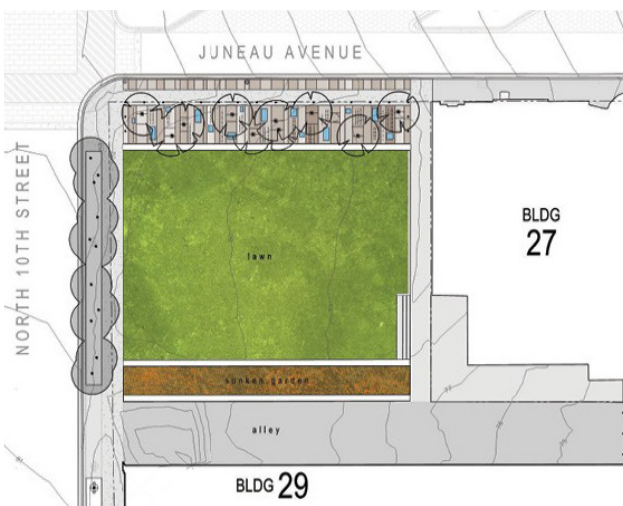

VENUE POINT OF CONTACT

Erin Stenum

414-899-2817

erin@thebrewery.org

www.thebrewery.org/parks

VENUE DESCRIPTION

Preservation Park is set in the heart of the Brewery District as a monument to the transformation of the former 21-acre campus of the Pabst Brewery to one of downtown Milwaukee's newest, vibrant and mixed-use neighborhoods called The Brewery District. Preservation Park features a walkway etched with the Brewery District's history, artifact boxes recessed into metal panels and a 13 dock Bublr Bikeshare station.

VENUE INFORMATION

Capacity: 101-500

Number of Event Spaces: 1

Outdoor Space: Yes

ADA Accessible: Yes

Employee Makeup: Non-Union Employees

Venue Ownership: --

VENUE BREAKDOWN

Space Sq Ft: 5,001-10,000 Sq Ft

Largest Capacity Space: n/a

Cocktail Capacity: n/a

Theater Capacity: n/a

Classroom Capacity: n/a

Boardroom Capacity: n/a

Banquet Capacity: n/a

VENUE CAN ACCOMMODATE

The information included in this listing has been provided by the venue.

Para español, por favor visite milwaukee2020.com/venue-search.

For more information, visit milwaukee2020.com/venue-search.